

432E BACKHOE LOADER | 8T

PRODUCT SPECIFICATIONS

CAT

Engine	
Engine Model	CAT C15 ACERT
Scraper Engine	CAT C9 ACERT
Tractor Engine	
Net Power	345/373 kW / 462/500 hp
Gross Power – Gears 1-2	364 kW / 488 hp
Gross Power – Gears 3-8	392 kW / 526 hp
Net Power – Gears 1-2	345 kW / 462 hp
Net Power – Gears 3-8	373 kW / 500 hp
Bore	145 mm / 5.7"
Stroke	183 mm / 7.2"
Displacement	18.1 L / 1,105 ⁱⁿ³
Net power advertised is the power available at rated speed of 1,800 rpm, measured at flywheel when the engine is equipped with fan, air cleaner, muffler and alternator. Net power ratings apply at 1,800 rpm when tested under the specified standard conditions for ISO 9249 and EEC 80/1269.	
Scraper Engine	
Net Power	198/211 kW / 266/283 hp
Gross Power – Gear 1	213 kW / 286 hp
Gross Power – Gears 2-4	226 kW / 303 hp
Net Power – Gear 1	198 kW / 266 hp
Net Power – Gears 2-4	211 kW / 283 hp
Bore	112 mm / 4.4"
Stroke	149 mm / 5.9"
Displacement	8.8 L / 538 ⁱⁿ³
Weights	
Total Operating - Empty	39,372 kg / 86,800 lb
Total Operating - Loaded	63,332 kg / 139,601 lb
Hydraulics	
Bowl Cylinder Bore	184 mm / 7.2"
Bowl Cylinder Stroke	873 mm / 34.4"
Apron Cylinder Bore	210 mm / 8.2"
Apron Cylinder Stroke	727 mm / 28.6"
Ejector Cylinder Bore	210 mm / 8.2"
Ejector Cylinder Stroke	1,880 mm / 74"
Steering Circuit	379 L/min / 100 gal/min
Scraper Circuit	344 L/min / 91 gal/min
Cushion Hitch Circuit	34.5 L/min / 9 gal/min
Secondary Steering Circuit	379 L/min / 100 gal/min
Relief Valve – Steering Circuit	13 700 kPa / 1,987 psi
Relief Valve – Implement Circuit	14 000 kPa / 2,030 psi

Scraper Bowl	
Heaped Capacity	26 m ³ / 34 yd ³
Rated Load	37,285 kg / 82,200 lb
Struck Capacity	18.3 m ³ , 24 yd ³
Depth of Cut – Maximum	437 mm / 17.2"
Width of Cut - To router bits	3,512 mm / 138.3"
Ground Clearance – Maximum	545 mm / 21.5"
Cutting Edge – Thickness	28 mm / 1.12"
Hyd. Penetration Force	360 kN / 81,000 lb
Depth of Spread – Maximum	480 mm / 18.9"
Apron Opening	2,007 mm / 79"
Apron Closure Force	170 kN / 38,250 lb
Transmission	
Forward 1	5.5 kph / 3.4 mph
Forward 2	10.0 kph / 6.2 mph
Forward 3	12.2 kph / 7.6 mph
Forward 4	16.6 kph / 10.3 mph
Forward 5	22.2 kph / 13.8 mph
Forward 6	30.1 kph / 18.7 mph
Forward 7	40.6 kph / 25.2 mph
Forward 8	54.9 kph / 34.1 mph
Reverse	9.9 kph / 6.2 mph
Fuel Burn	
Low	48.8 - 72.1 Litres per hour
Medium	72.3 - 95.8 Litres per hour
High	95.8 - 125.3 Litres per hour

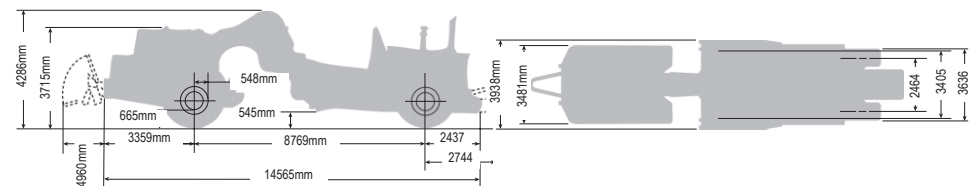

DISCLAIMER: This Product Specification Sheet was produced 01/2020. Every effort has been made to ensure that the content is accurate, however the contents are subject to change. Information contained in this Specification Sheet is for general information only and does not purport to be comprehensive, current only at the time it is placed in this document compiled from manufacturer and industry sources; and not intended to provide nor make any recommendation upon which you should rely for any purpose whatsoever. Ezyquip Hire makes no warranty express or implied, including without limitation any warranty of merchantability or fitness for any particular purpose. Ezyquip Hire shall not be liable for any special, incidental, or consequential damages or loss of profits resulting from use of or misuse of the general information provided in this document.